

Meeting Room Floor Plans

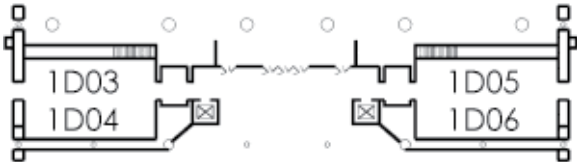

Rooms 1D03-1D06



Meeting Room Capacities

Room	Floor Dim. (feet)	Occupancy (theater/classroom)
1D03	30'x25'	65/44
1D04	30'x24'	65/44
1D05	30'x25'	65/44
1D06	30'x24'	65/44

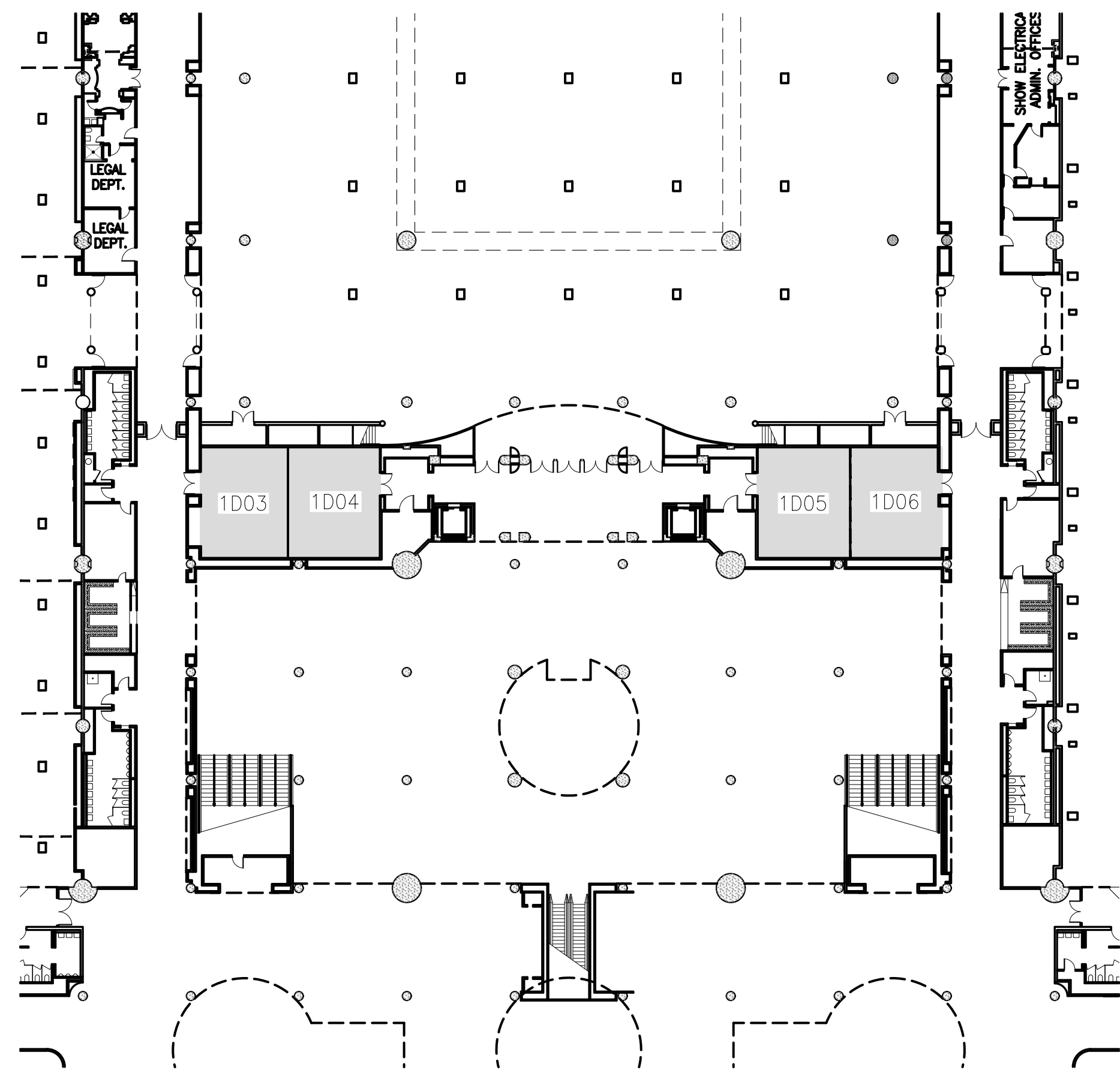

HALL 1D WITH CENTER PARTITION

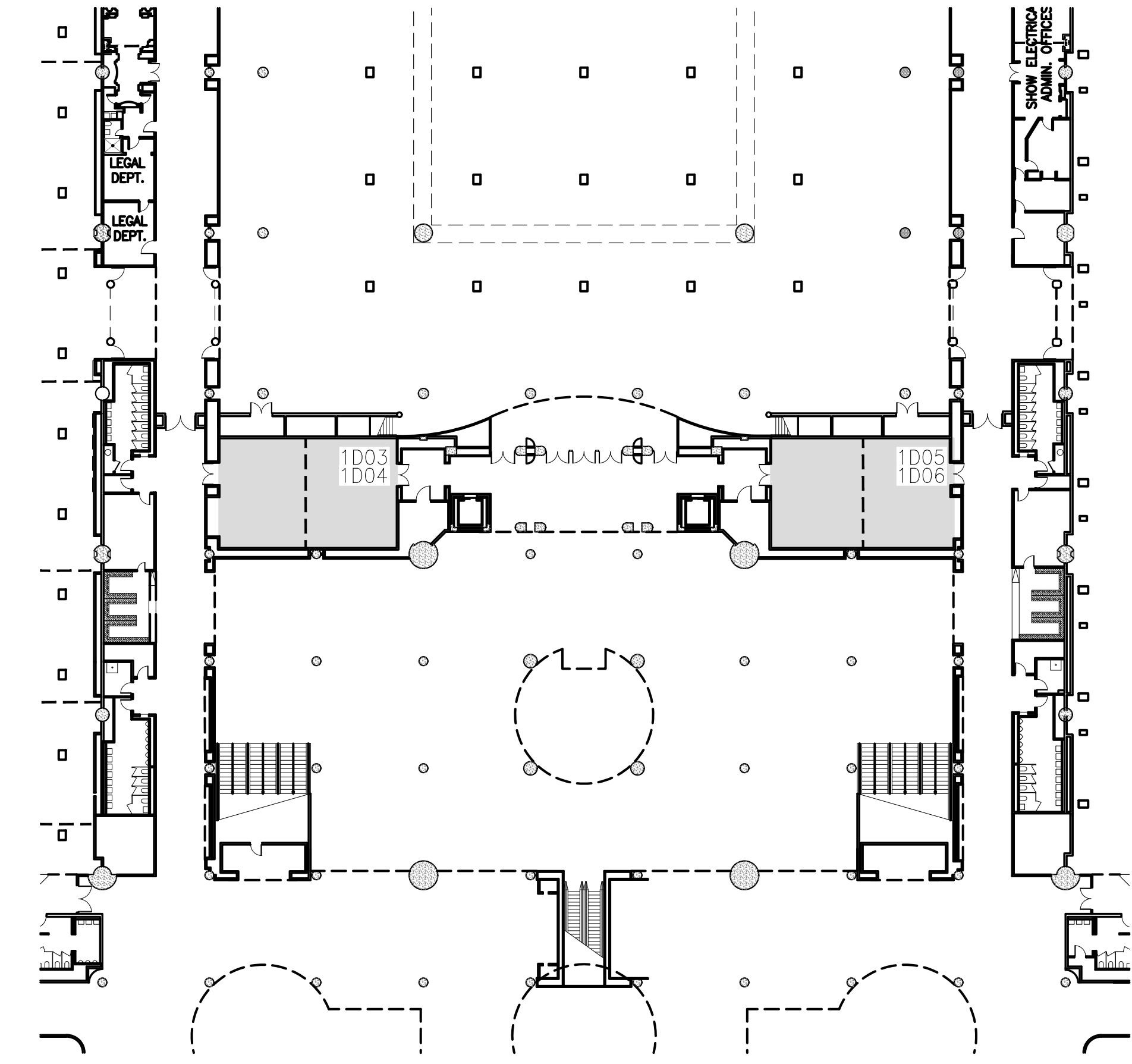

HALL 1D WITHOUT CENTER PARTITION

The Jacob K. Javits Convention Center of New York
 Meeting Room Layouts
 655 W34th Street, New York, NY 10001

ARCHITECT: **di Domenico + Partners** LLP
 Architecture
 Landscape Architecture
 Planning
 37-43 Crescent Street
 Long Island City, New York 11101
 Tel 212.337.0400
 Fax 212.337.3567
 ddp-ny.com

- LEGEND:**
- EXIT SIGN
 - OCCUPANCY SIGN
 - TABLE ZONE
 - MAXIMUM OCCUPANCY
 - ACTUAL OCCUPANCY
 - CHAIR
 - HANDICAPPED VIEWING POSITION

REV	DESCRIPTION	DATE

DRAWING TITLE :
**KEY PLAN
 EAST CORE MEETING ROOMS
 HALL 1D**

PROJECT No : 16306
 DRAWN BY : CE
 CHECKED BY : AB
 SCALE : 1/32" = 1'-0"
 DRAWING No:
A400.00

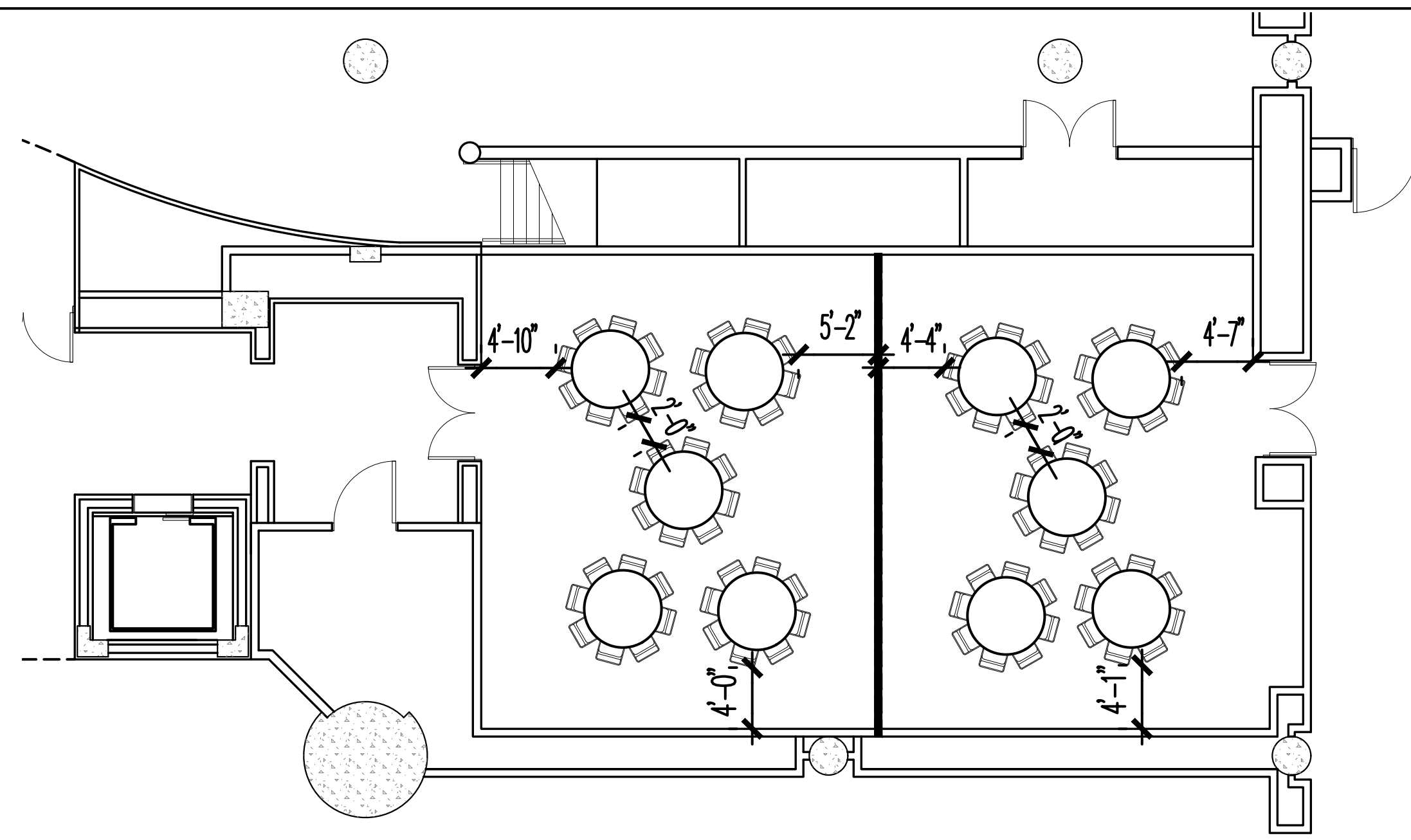

HALL 1D03 & 1D04 EAST CORE

TOTAL CHAIRS: 40 PER SIDE

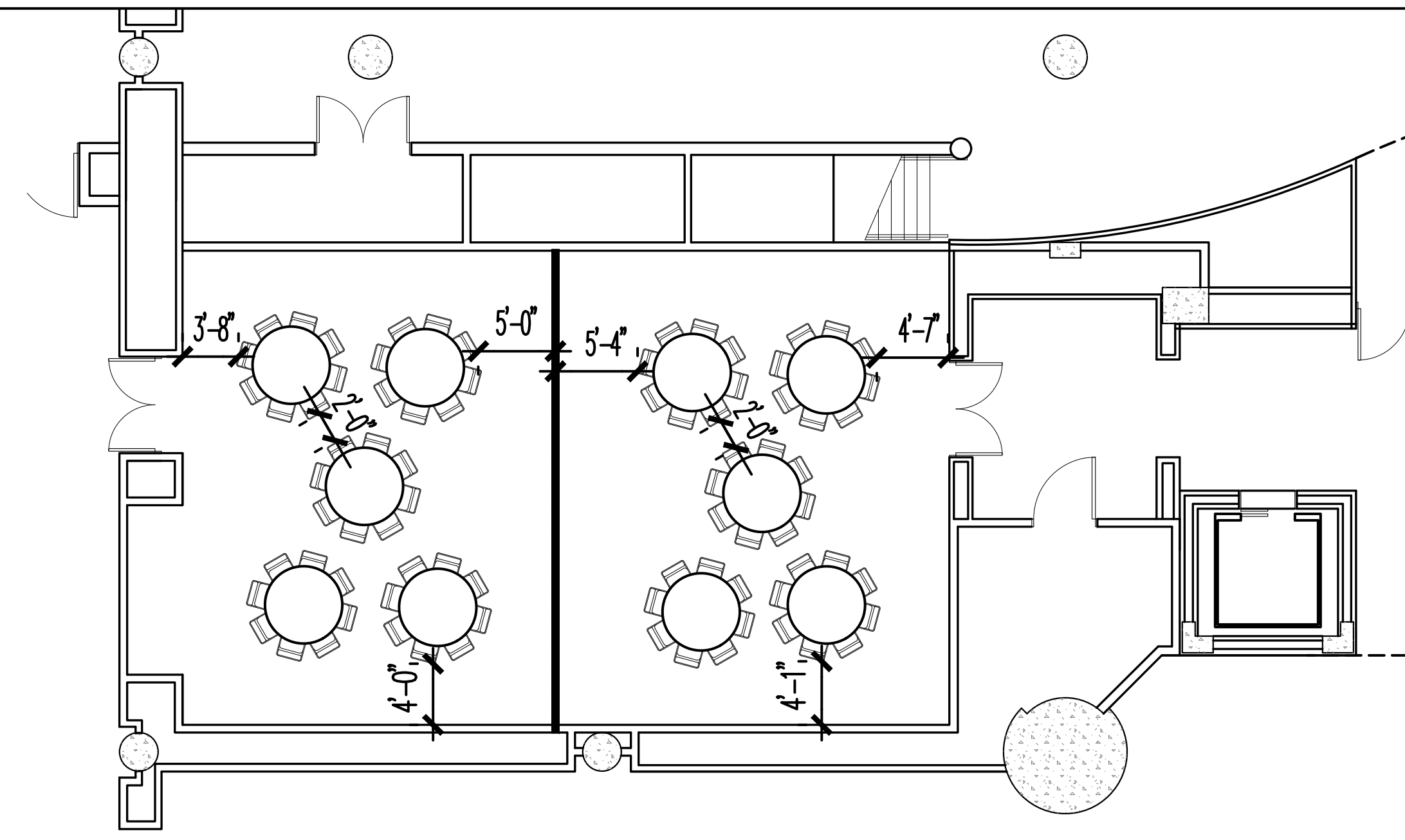

HALL 1D05 & 1D06 EAST CORE

TOTAL CHAIRS: 40 PER SIDE

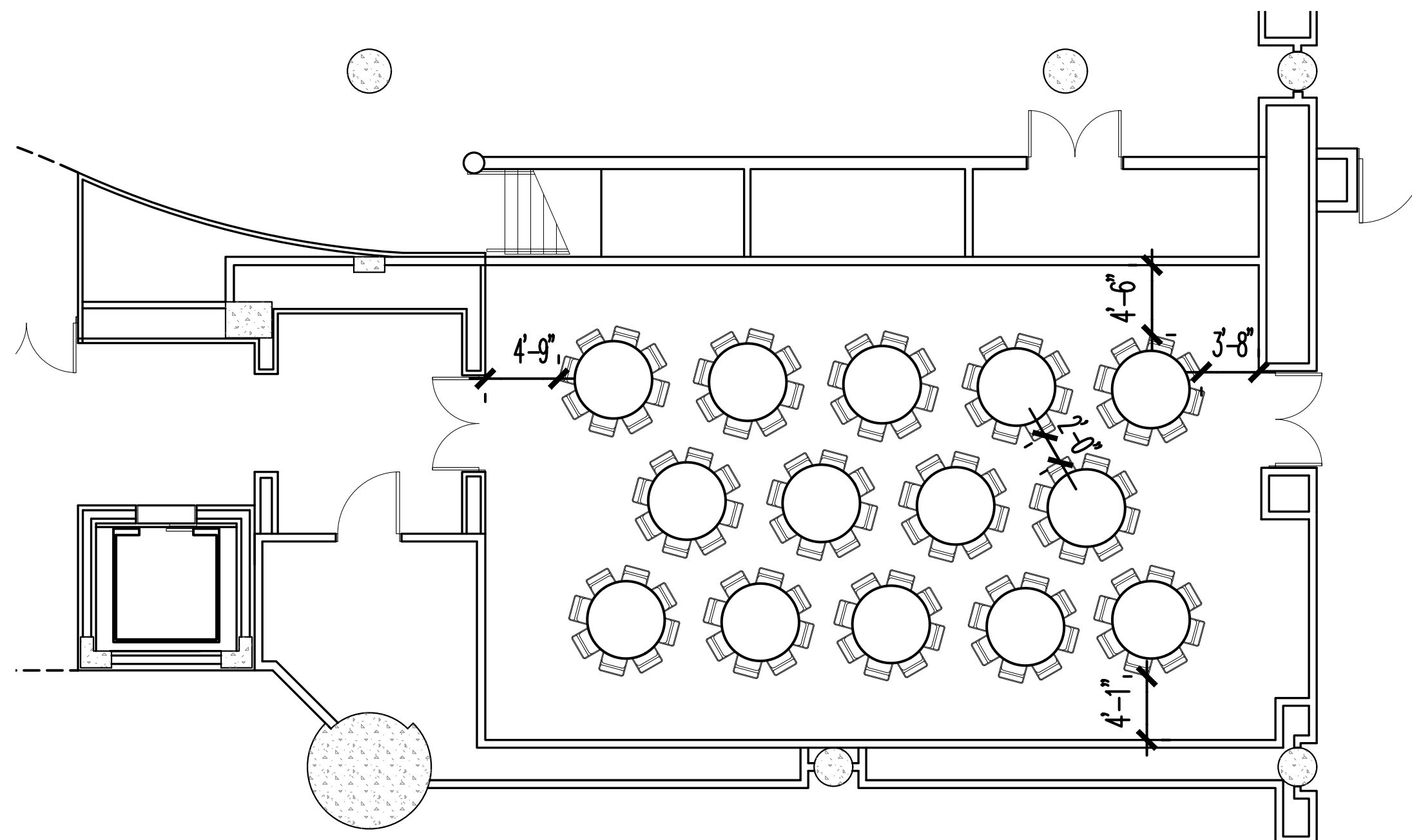

HALL 1D03 & 1D04 EAST CORE

TOTAL CHAIRS: 112

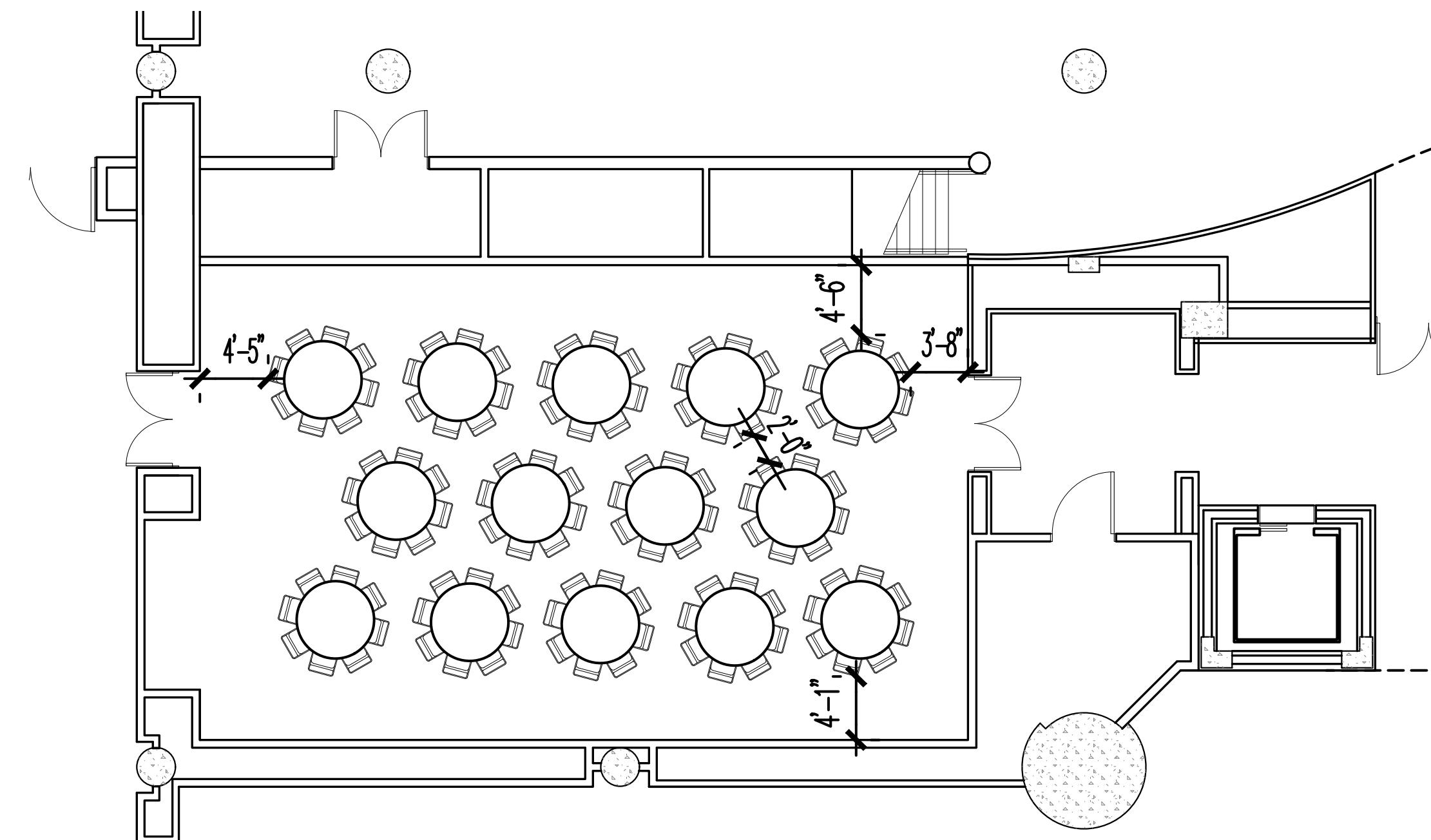

HALL 1D05 & 1D06 EAST CORE

TOTAL CHAIRS: 112

NOTE: TOTAL CHAIR COUNT INCLUDES HANDICAPPED AND HEADTABLE.

The Jacob K. Javits Convention Center of New York
Meeting Room Layouts
655 W34th Street, New York, NY 10001

ARCHITECT: **di Domenico + Partners** LLP
Architecture
Landscape Architecture
Planning
37-43 Crescent Street
Long Island City, New York 11101
Tel 212.337.0400
Fax 212.337.3567
ddp-ny.com

- LEGEND:**
- ⊙ EXIT SIGN
 - ⊞ OCCUPANCY SIGN
 - TABLE ZONE
 - MAXIMUM OCCUPANCY
 - ACTUAL OCCUPANCY
 - CHAIR
 - H HANDICAPPED VIEWING POSITION

REV	DESCRIPTION	DATE

DRAWING TITLE :
**BANQUET ARRANGEMENT
EAST CORE MEETING ROOMS
HALL 1D**

PROJECT No : 16306
DRAWN BY : CE
CHECKED BY : AB
SCALE : 1/8" = 1'-0"
DRAWING No :
A401.00

P:\16306 - JKC - Meeting Room Layouts\3.0 Project Design\7.1 Drawings\Banquet\A-401-Banquet Style_East Core Meeting Rooms_1D.dwg 03/23/16 - 6:21pm

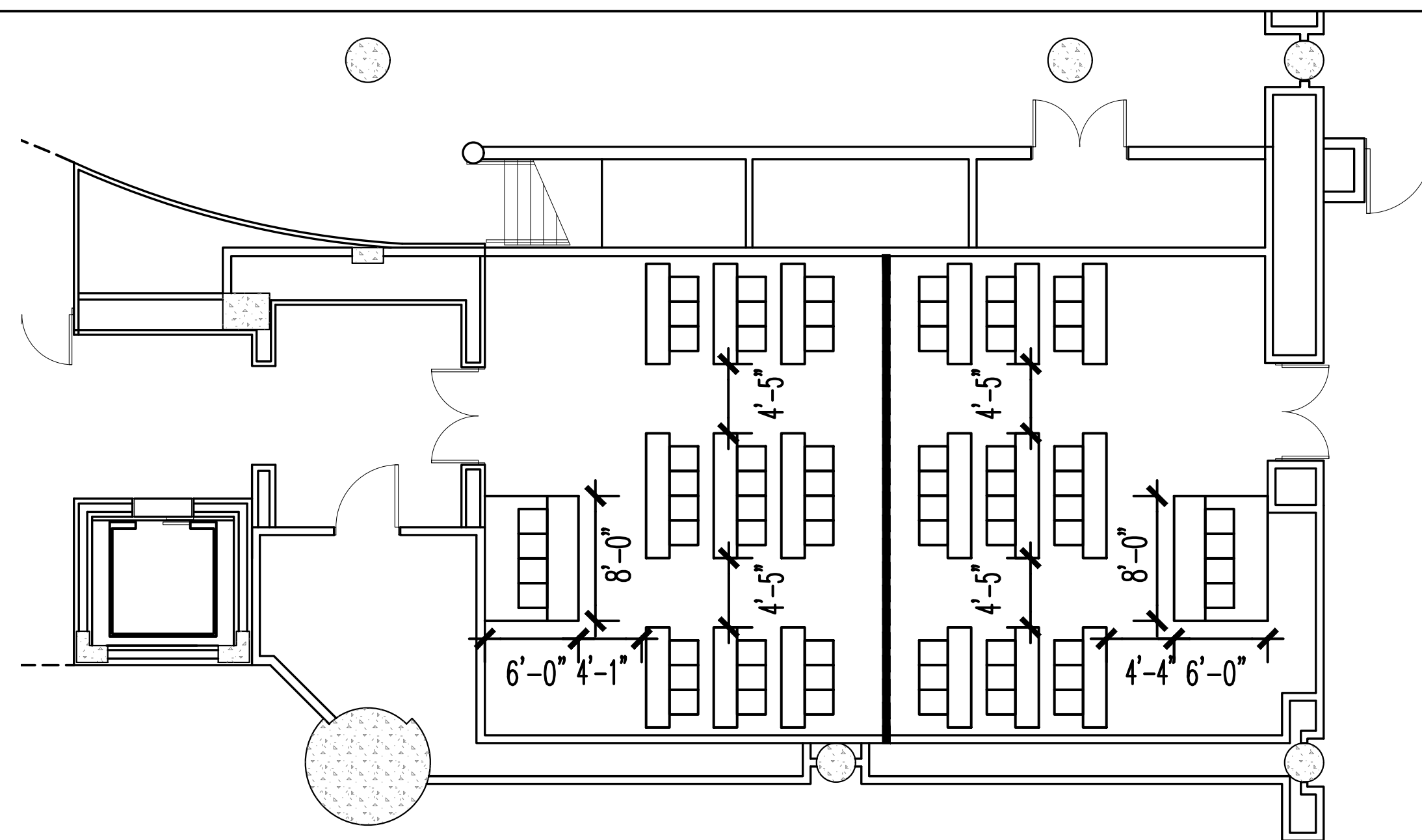

HALL 1D03 & 1D04 EAST CORE

TOTAL CHAIRS: 34 PER SIDE

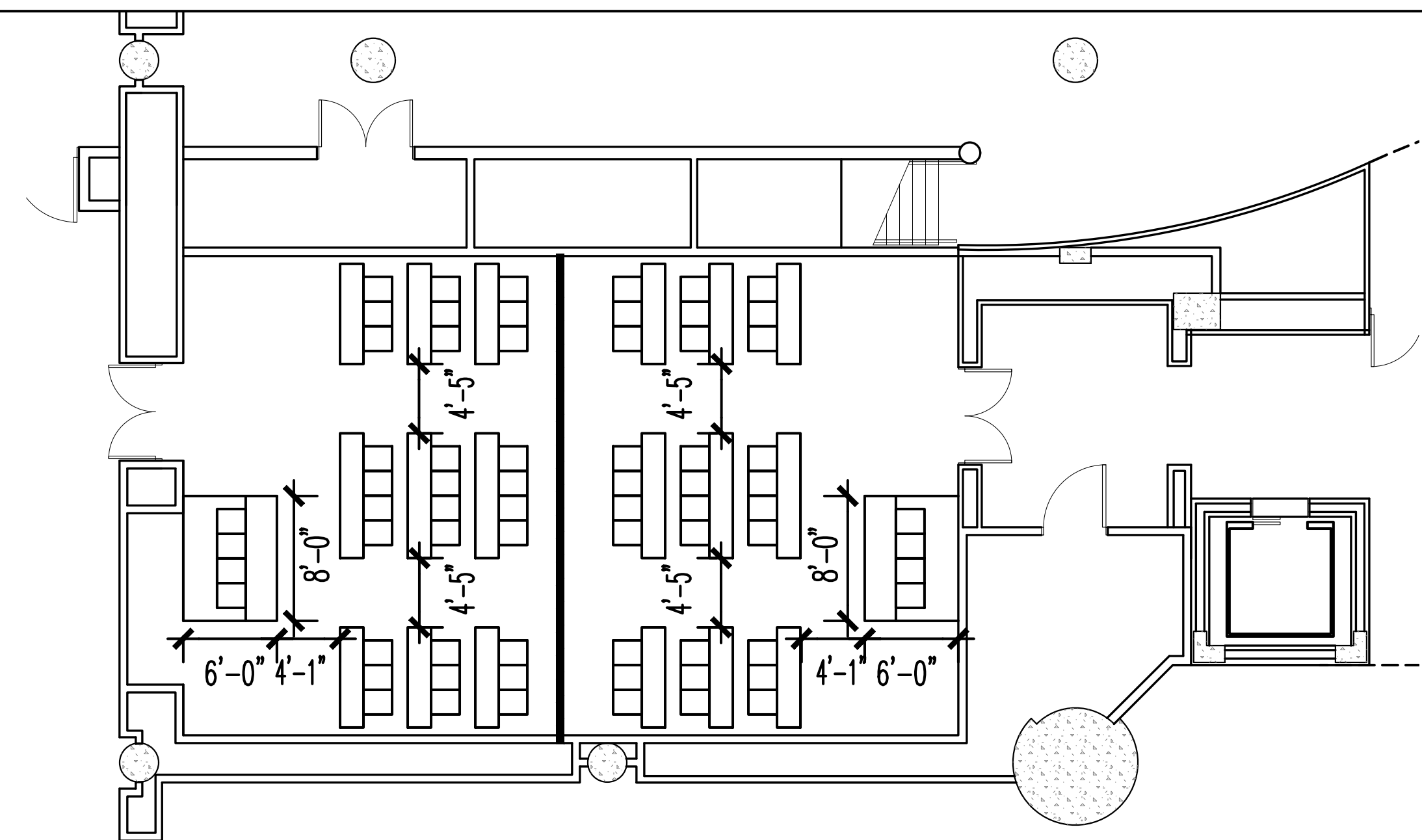

HALL 1D05 & 1D06 EAST CORE

TOTAL CHAIRS: 34 PER SIDE

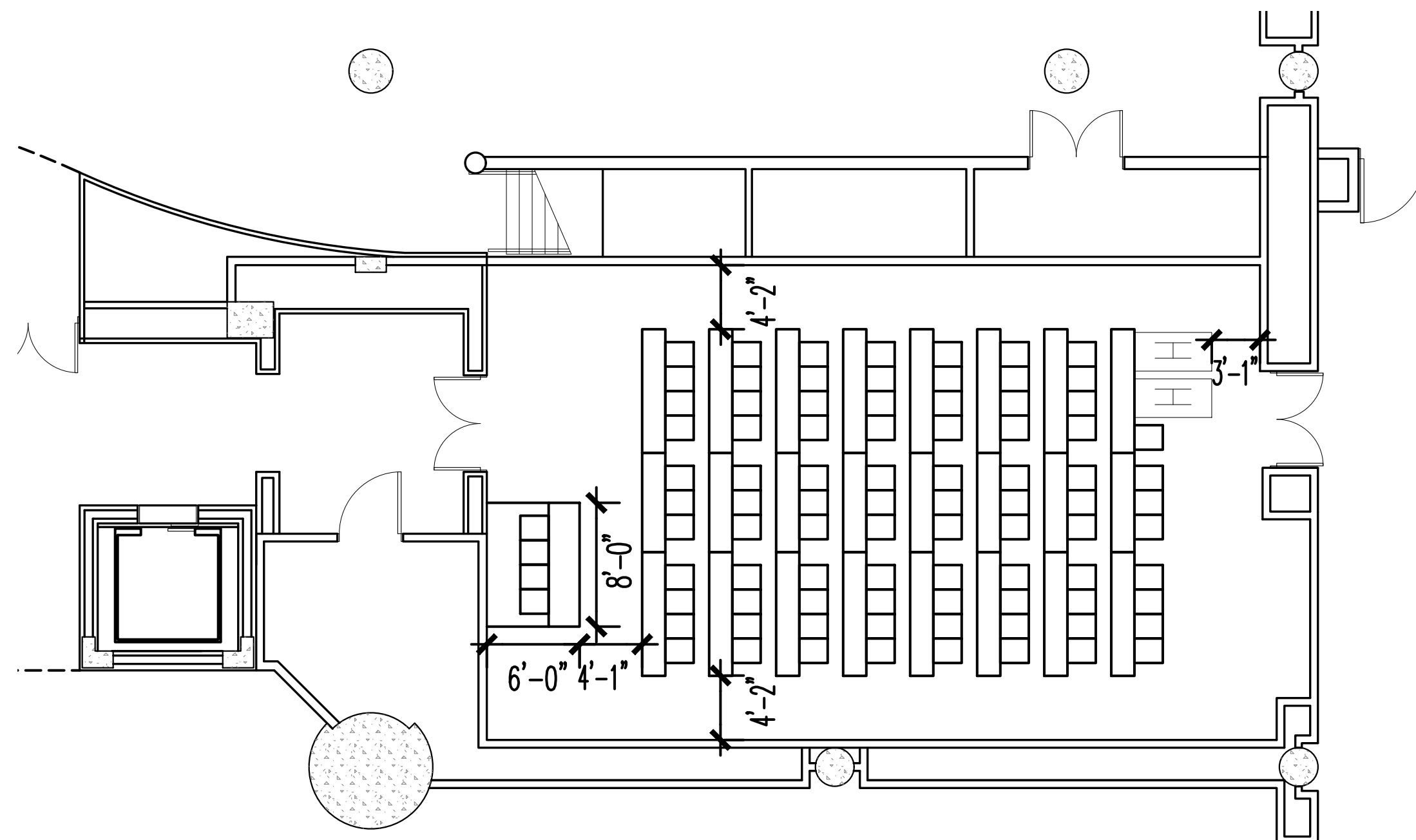

HALL 1D03 & 1D04 EAST CORE

TOTAL CHAIRS: 91

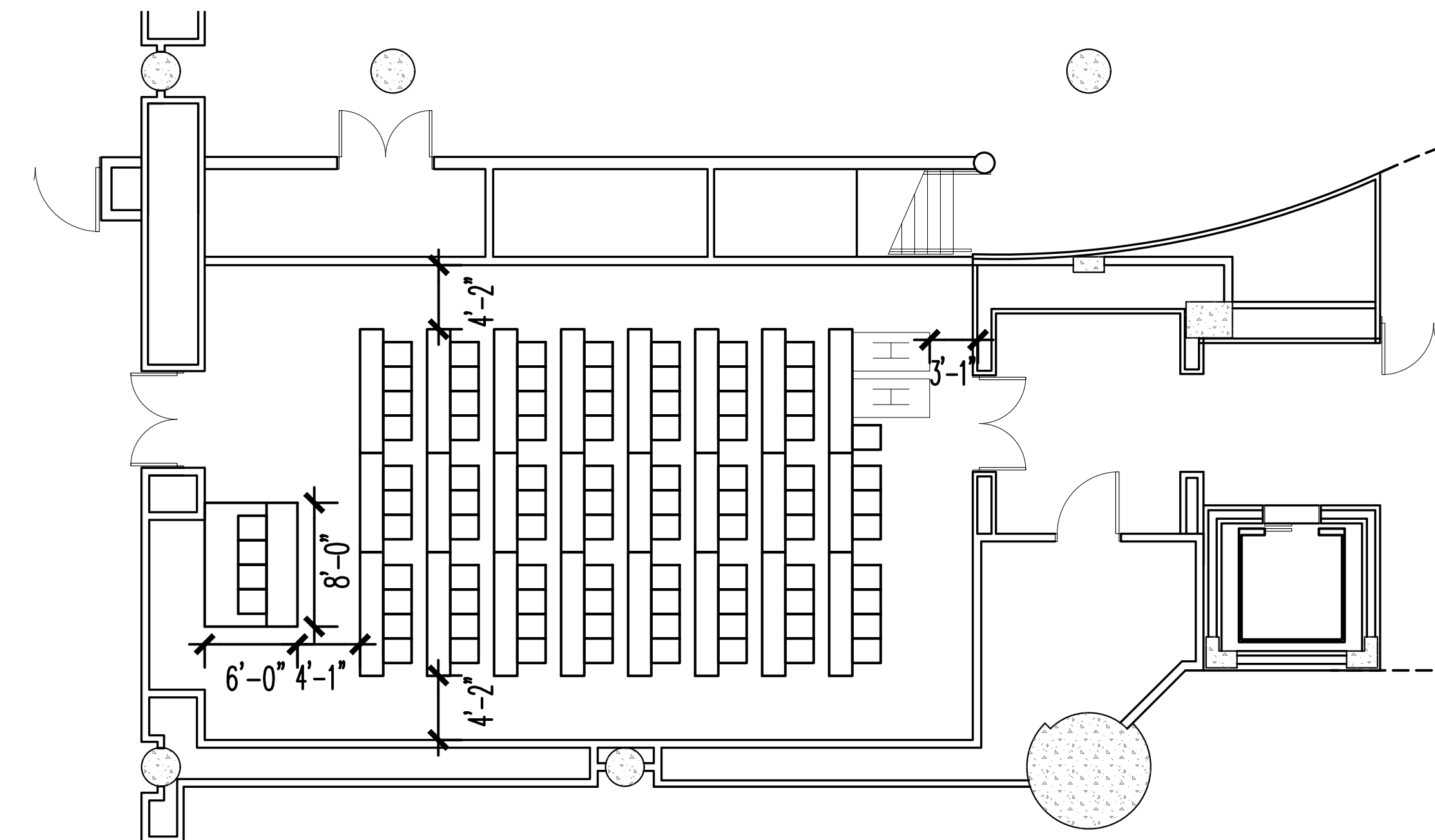

HALL 1D05 & 1D06 EAST CORE

TOTAL CHAIRS: 91

NOTE: TOTAL CHAIR COUNT INCLUDES HANDICAPPED AND HEADTABLE.

The Jacob K. Javits Convention Center of New York
Meeting Room Layouts
655 W34th Street, New York, NY 10001

ARCHITECT: **dd**
di Domenico + Partners LLP
Architecture
Landscape Architecture
Planning
37-43 Crescent Street
Long Island City, New York 11101
Tel 212.337.0400
Fax 212.337.3567
ddp-ny.com

- LEGEND:**
- EXIT SIGN
 - OCCUPANCY SIGN
 - TABLE ZONE
 - MAXIMUM OCCUPANCY
 - ACTUAL OCCUPANCY
 - CHAIR
 - HANDICAPPED VIEWING POSITION

REV	DESCRIPTION	DATE

DRAWING TITLE :
**CLASSROOM ARRANGEMENT
EAST CORE MEETING ROOMS
HALL 1D**

PROJECT No: 16306
DRAWN BY: CE
CHECKED BY: AB
SCALE: 1/8" = 1'-0"
DRAWING No: A401.00

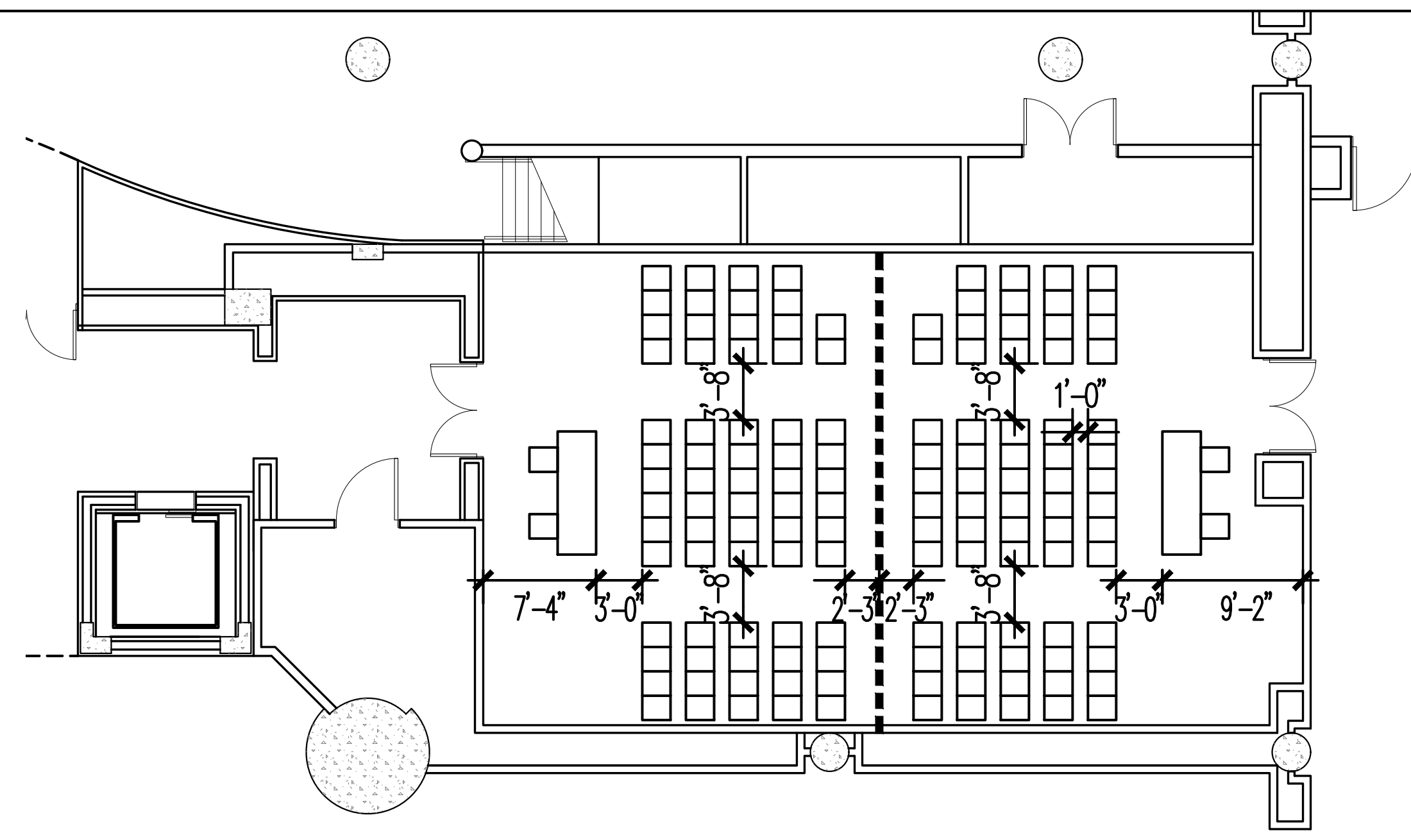

HALL 1D03 & 1D04 EAST CORE

TOTAL CHAIRS: 70 @ 34" O.C. PER SIDE

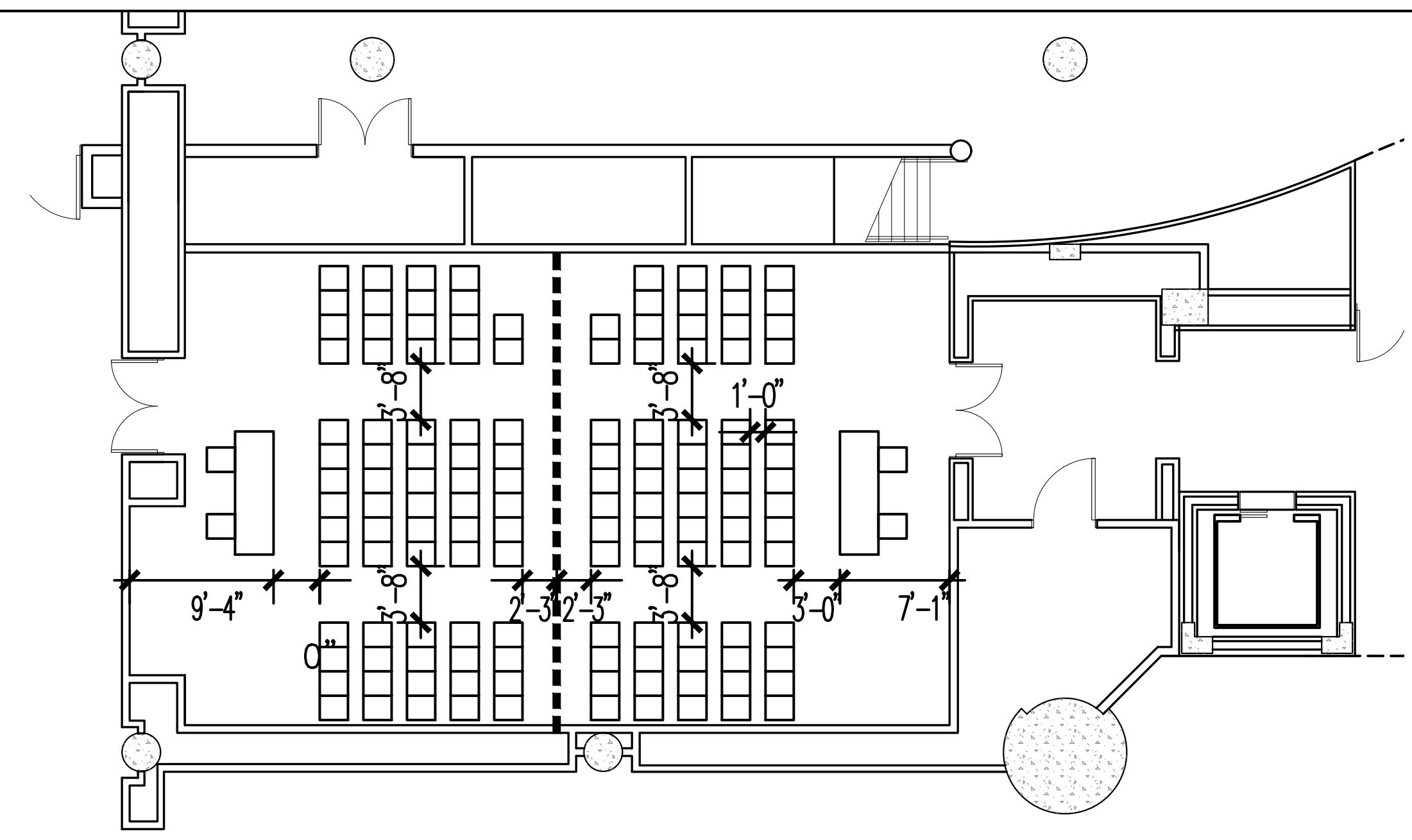

HALL 1D05 & 1D06 EAST CORE

TOTAL CHAIRS: 70 @ 34" O.C. PER SIDE

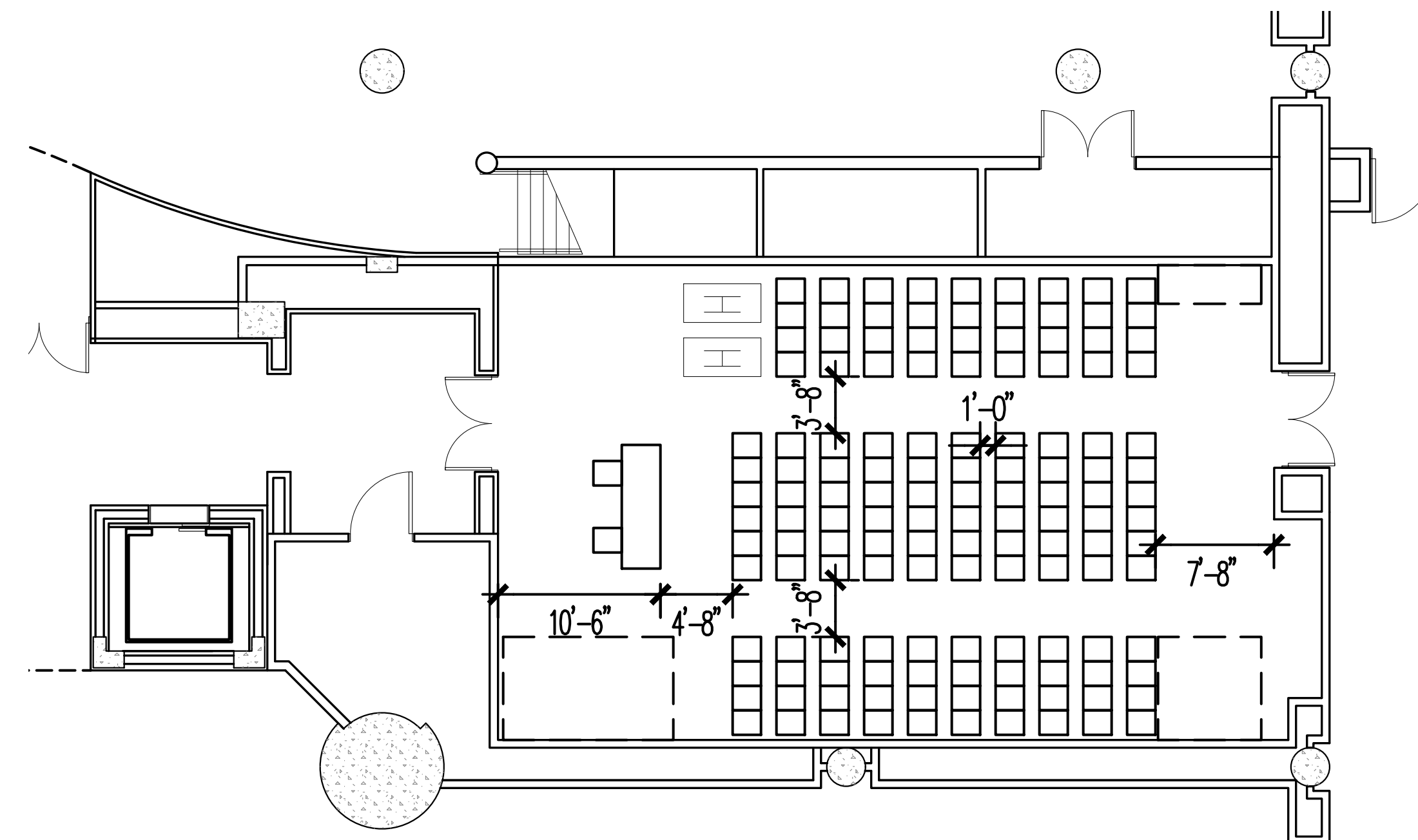

HALL 1D03 & 1D04 EAST CORE

TOTAL CHAIRS: 140 @ 34" O.C.

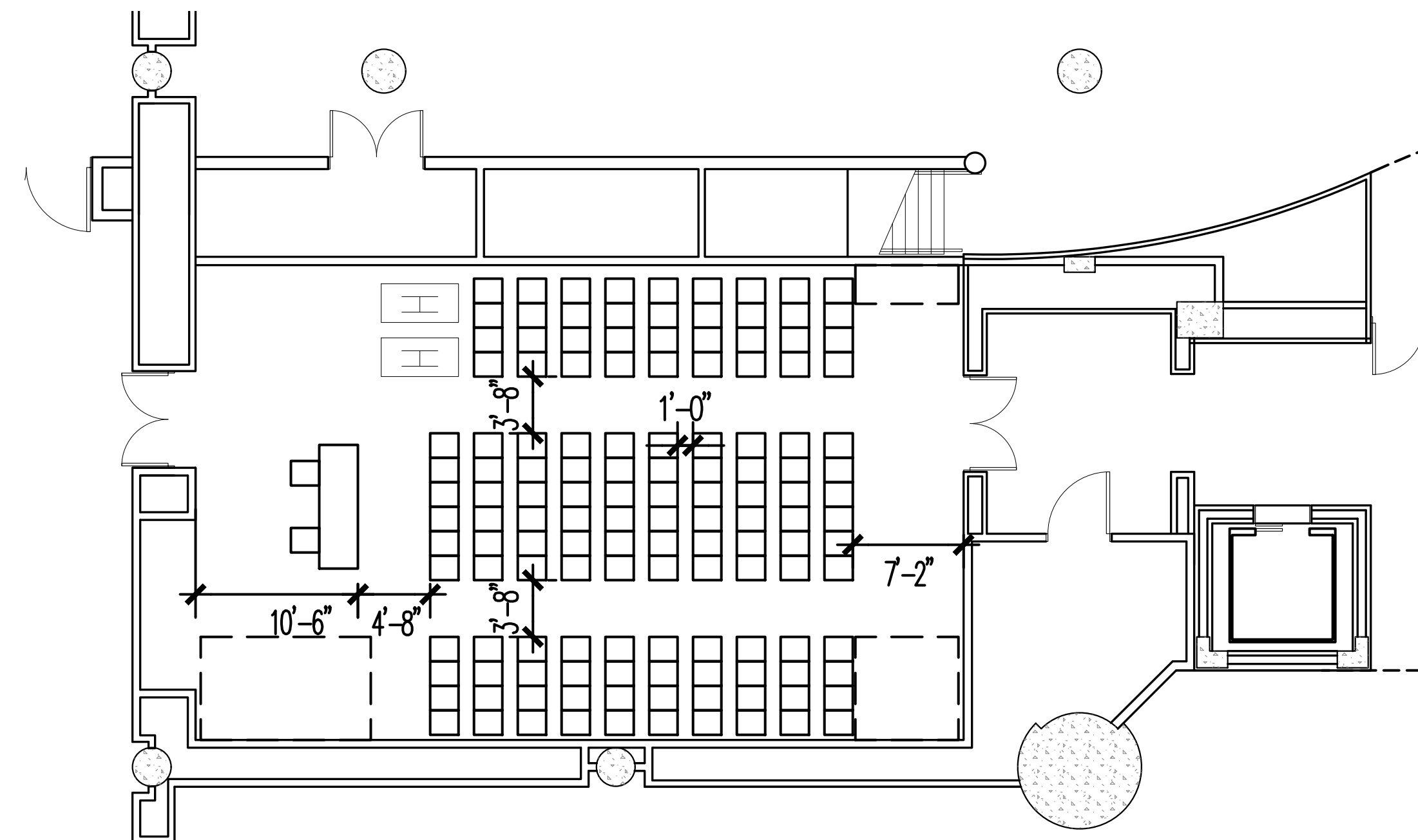

HALL 1D05 & 1D06 EAST CORE

TOTAL CHAIRS: 140 @ 34" O.C.

NOTE: TOTAL CHAIR COUNT INCLUDES HANDICAPPED AND HEADTABLE.

The Jacob K. Javits Convention Center of New York
Meeting Room Layouts
655 W34th Street, New York, NY 10001

ARCHITECT: **dd**
di Domenico + Partners LLP
Architecture
Landscape Architecture
Planning
37-43 Crescent Street
Long Island City, New York 11101
Tel 212.337.0400
Fax 212.337.3567
ddp-ny.com

- LEGEND:**
- EXIT SIGN
 - ☒ OCCUPANCY SIGN
 - TABLE ZONE
 - CHAIR
 - MAXIMUM OCCUPANCY
 - ACTUAL OCCUPANCY
 - H HANDICAPPED VIEWING POSITION

REV	DESCRIPTION	DATE

DRAWING TITLE :
THEATER/MEETING ARRANGEMENT
EAST CORE MEETING ROOMS
HALL 1D

PROJECT No : 16306
DRAWN BY : CE
CHECKED BY : AB
SCALE : 1/8" = 1'-0"
DRAWING No : A401.00